



**Road Running Technical Council
USA Track & Field
Measurement Certificate**



Name of the course Dutchess County Classic Half-Marathon Distance 21.0975 km
Location (state) NY (city) Poughkeepsie
Type of course: Road Race
Measuring Methods: Steel Tape & Bicycle
Measured By Jim Gilmer, 232 Van Wies Point Rd, Glenmont, NY 12077, jim.gilmer@gmail.com, 518-852-3562
Race Contact Tom Storey, 15 Fox Run Wappingers Falls, NY 12590 thomascstorey@yahoo.com, 845-453-6316
Date(s) when course measured: 06/01/2022, 06/07/2022, 06/21/2022
Number of measurements of entire course: 2 Course Configuration: Complex of loops
Elevation (meters above sea level) Start 71.00 Finish 71.00 Lowest 14.00 Highest 72.00
Straight line distance between start and finish 0.0m Drop 0.00 m/km Separation 0.00 %
Type of surface: Paved 100 % Dirt 0 % Gravel 0 % Grass 0 % Track 0 %
Effective date of certification: July 5, 2022 Certification code: NY22008JG

Note to Race Director: Use this Certification Code
in all public announcements relating to your race.

Be It Officially Noted That

Based on examination of data provided by the above named measurer, the course described above and in the map attached is hereby certified as reasonably accurate in measurement according to the standards adopted by the Road Running Technical Council. If any changes are made to the course, this certification becomes void, and the course must then be recertified.

Verification of Course --- In the event a National Open Record is set on the course, or at the discretion of USA Track & Field, a verification measurement may be required to be performed by a member of the Road Running Technical Council. If such a remeasurement shows the course to be short, then all pending records will be rejected and the course certification will be cancelled.

This certification expires on December 31 of the year: **2032**

AS NATIONALLY CERTIFIED BY:

Date: July 5, 2022
Jim Gilmer - USATF/RRTC Certifier - 232 Van Wies Point Rd, Glenmont NY 12077
(518) 852-3562 - jim.gilmer@gmail.com

Dutchess County Classic Half Marathon 2022

Poughkeepsie, NY



USATF Certificate

NY22008JG

Effective: 07/05/2022
Through: 12/31/2032

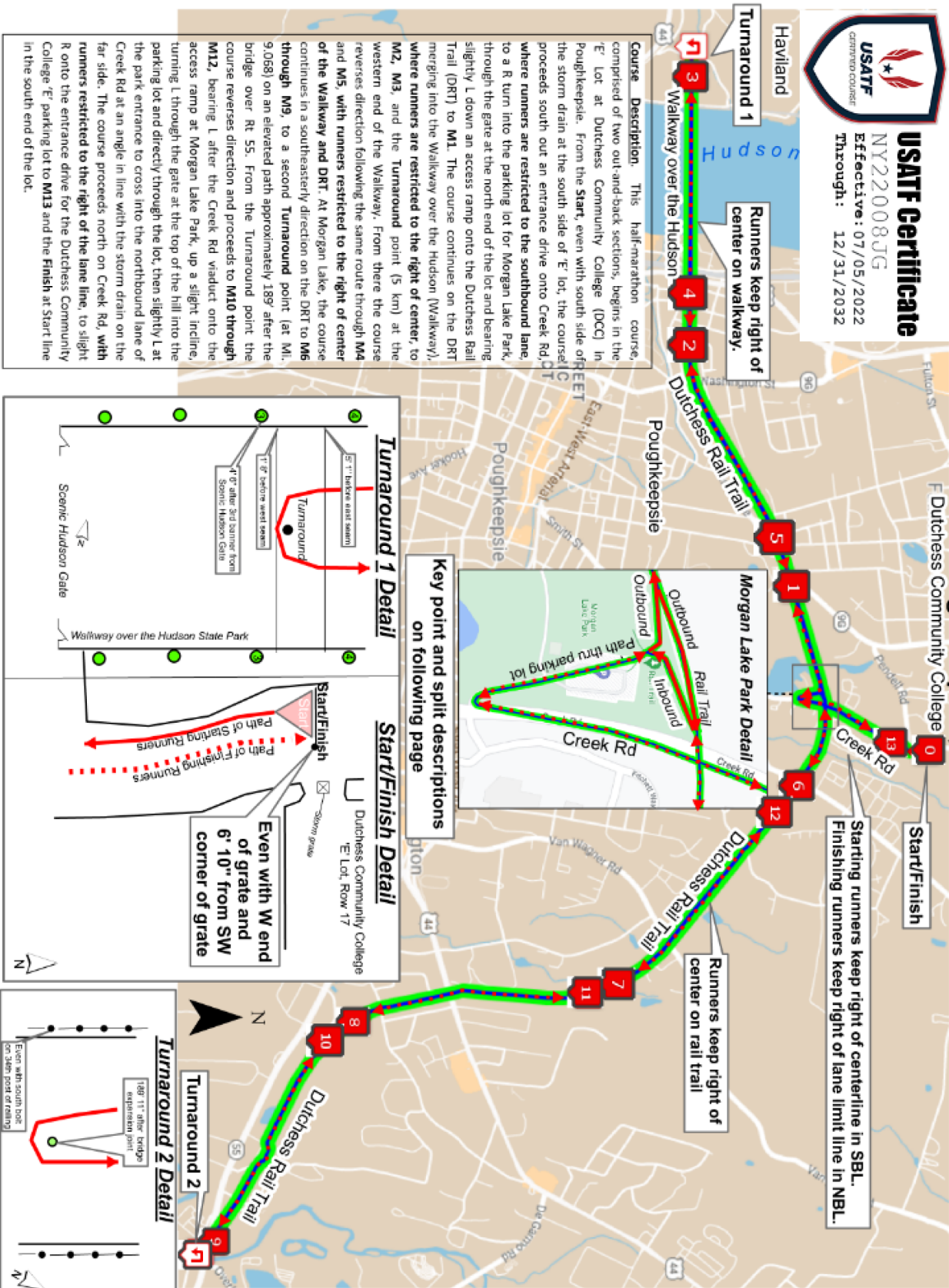

Key Points: Dutchess County Classic Half-Marathon		
Point	Coordinates	Description
Start/Finish	41.723149°, -73.903049°	At south end of Dutchess Community College "E" Lot. Line is even with storm grate at west end of Row E17, 6' 10" from SE corner of grate. Marked with nail and "S/F" in white paint.
Mile 1	41.716072°, -73.914740°	On Dutchess Rail Trail (DRT) before Parker Ave overpass tunnel. Point is 11' 3" before E/edge of storm grate on L. Marked with nail and yellow paint.
Mile 2	41.710545°, -73.932320°	On Walkway Over the Hudson (Walkway), west bound. Point is 6 slab seams plus 1' 0" after electric junction box on L. Marked on R with yellow tape on railing and small yellow paint dot.
Mile 3	41.710673°, -73.951697°	On Walkway, west bound. Point is 7 slab seams plus 2' 8" after electric junction box on L and 1' before end post of tall black wire mesh safety fence. Marked on R with yellow tape on railing
Turnaround #1/ 5 km	41.710665°, -73.953705°	On Walkway, 130' 6" east of Scenic Hudson Gate. Point is in middle of walkway, 4' 6" after 3 rd banner; 1' 8½" after west joint and 5' 1" before east joint of first full slab. Marked on railings with yellow and blue tape, plus small yellow paint dot in middle of Walkway for placement of turnaround cone.)
Mile 4	41.710563°, -73.936447°	On Walkway, east bound, at 14 th post plus 1' 2" before end of tall black wire mesh safety fence on R and 25' before nearest electric junction box. Marked with yellow tape on railing.
Mile 5	41.715113°, -73.918626°	On DRT, west bound, before Buckingham Ave xing between posts 7 & 8 in post & rail fence on right. Point is 7' 11" after post 7 and 2' 1" before post 8. Marked on R with nail and yellow paint.
Mile 6	41.716251°, -73.900546°	On DRT after bridge over Rt 115. Point is between post 5 & 6 from end of fence on right. Marked with nail and green paint.
Mile 7	41.706679°, -73.886212°	On DRT, approx. 1,280' (.24 mi) after bridge over Rt 38 (Van Wagner Rd). No other reference available. Marked with nail and green paint.
Mile 8	41.692532°, -73.883573°	On DRT approx. 350' after Overocker Rd trail parking area. No other reference available. Marked with nail and green paint.
Mile 9	41.684843°, -73.867730°	On DRT, on bridge over Rt 55. Point is 31' 6" after expansion joint. Marked with green paint only.
Turnaround #2/ 9.068 mi.	41.684175°, -73.866865°	On DRT elevated concrete trail, 189' 11" after south expansion joint for bridge over Rt 55. Point is even with southern-most plate bolt at 34th railing post after bridge. Marked in green paint with dot inscribed in a circle in the center of the trail along with green tape on railings on either side
Mile 10	41.691071°, -73.882231°	On DRT, 47' 6" before "Demarco" bench on R. Marked with nail and green paint.
Mile 11	41.704944°, -73.885425°	On DRT, 10' 8" before "Warning-Steep Slopes" sign on R. Marked with nail and green paint.
Mile 12	41.715117°, -73.898688°	On DRT, 73' before "Building the Rail Trail" sign on L. Marked with nail and green paint.
Mile 13	41.721690°, -73.903539°	At entrance to DCC 'E' lot off northbound lane of Creek Rd. Point is 50' 6" before "One Way" sign on lot entrance drive. Marked with nail and green paint.
Note: Described as course is run. Splits are not certified and marked as described above.		